

SERVICES

Book Collection

Adult

Children

Magazines

Pamphlet File

Newspapers

Talking Books

Meeting Rooms

Phono Disos

Picture File

Microfilm

Reference Service

Inter-Library Loan

Past Librarians

Mrs. Mack Harris

Mrs. Lura C. McColn

Margaret McCandless

Mrs. I. N. McIntire

Miss Lora Shipley

HISTORY

In 1895, Public library service was started in Sheldon through the efforts of the Ladies Chautauqua Literary and Scientific Circle. The Ladies earned \$56.20 by local entertainments, including an ice cream social. They opened library rooms March 15, 1895, over Smith Brothers Hardware Store. March 17, 1895, a fire destroyed the building.

Public spirited citizens restored the money to the ladies and a Public Library Association was formed, and incorporated on April 20, 1895. That fall the Sheldon Public Library was housed in Shipley and Company Drug Store and consisted of 200 volumes.

The library was given to the city in November, 1895, and shortly thereafter a tax for library support was voted. The library had a number of homes until the building at Fourth Avenue and Tenth Street was built in 1906. The building was financed by a grant from the Carnegie Foundation under the conditions that the city would maintain and support a library.

As the years went by, the Carnegie Library became too small to function effectively. A survey was made by Frederick Weizeman, presently Dean of the Library School, University of Iowa. The result of the survey was a recommendation that a new library be built.

A bond issue in the sum of \$90,000.00 was passed September, 1967. Federal funds were obtained, memorial gifts were made and the new library has become a reality.

Building construction costs	\$282,000.00
Equipment costs	36,000.00
	<hr/>
	\$298,000.00

Cost of the building per square foot	\$ 15.90
--------------------------------------	----------

ACKNOWLEDGEMENTS

Iowa State Traveling Library
Ernestine Grafton, Director

Iowa State Traveling Library Board
Mrs. John W. Crabb, Mrs. Charles R. Gee, William R. Sheridan, Arie M. Verrips, Mrs. Ralph Zastrow.

War Eagle Co-op Library
Bruce A. Tanner, Regional Administrator
Mrs. A. Van Roekel, Library Assistant
Mrs. Marvel Ballou, Library Aide
Mrs. Marie Westra, Library Aide

Pages
Cathy Hansen, Darla Van Roekel,
Edith Koerselman

City of Sheldon
Mayor W. R. Adkins
City Council

Dale Merrill, Wayne Bilsland, Ronald Drenkow, Harlan Klaahsen, Clarence Shaner

Library Trustees
Dr. A. H. Boeve, Chairman
Mrs. Vic Schulz, Vice-Chairman
Mrs. Marion Brower, Secretary
Dr. A. G. Korver
Paul Wolff
Daniel McPherson
Ralph Hollander
Rev. Gerald Eslinger, retired Chairman who served during the construction

Library Staff
Mrs. Helen O'Connor
Mrs. Marlene Bentz
Mrs. Eslie Jinkinson

Pages
Teddy Wolff, Edith Koerselman,
Cathy Hansen, Katy O'Connor

SHELDON PUBLIC LIBRARY • WAR EAGLE CO-OP LIBRARY

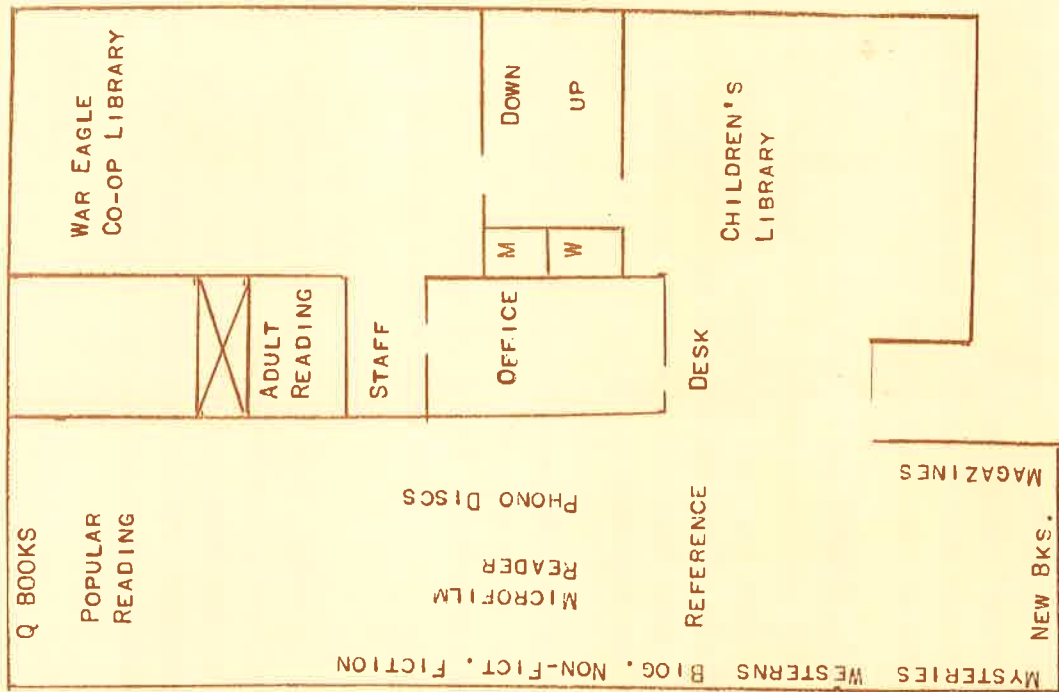

ARCHITECT — Wayne Stevens, A.I.A.
DeWild, Grant, Reckert & Associates Co.

GENERAL CONTRACTOR — Mow and Den Hartog

ELECTRICAL CONTRACTOR — Noack Electric

MECHANICAL CONTRACTOR — Overlee Plumbing

EQUIPMENT — Remington Rand Library Bureau
Midwest Beach

LANDSCAPING — FFA and Sunrise Kiwanis
Dr. A. G. Korver

DRAWINGS — Charles Tolk

